

CLASS

MATTEO NUNZIATI (2009)



DESCRIPTION

Class, design by Matteo Nunziati, is a sideboard characterized by modern aesthetics interpreted with harmony and elegance. An example of perfect balance between modernity and naturalness.

Poliform

CLASS

MATTEO NUNZIATI (2009)



TECHNICAL DESCRIPTION

TPOLOGY

Sideboard

STRUCTURE

Panel of wooden particles veneered spessart oak

BACK PANEL

Panel of wooden particles thickness 8 mm faced with melamine

EDGE

Veener spessart oak for the visible sides and decorative paper spessart oak for the other sides

DOOR

Panel of wooden particles thickness 25 mm veneered spessart oak

DRAWER FRONT

Panel of wooden particles thickness 25 mm veneered spessart oak

DRAWER STRUCTURE

Panel of wooden particles faced with melamine c. walnut

INNER EQUIPMENT

Cutlery holder

FEATURES

Possibility to have shalves and drawer front in hide. The drawers run on metal slide runners with ball bearing, partially extractable and soft closing

Poliform

CLASS

MATTEO NUNZIATI (2009)

MCS1

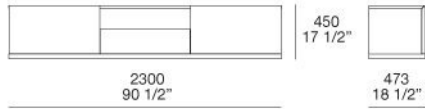

MCS2

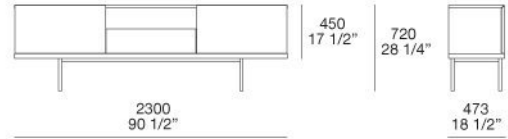

MCS3

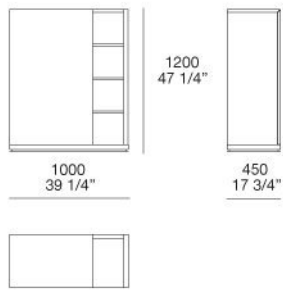

CLASS

FINISHINGS\SIDEBOARD\WOODS (1)

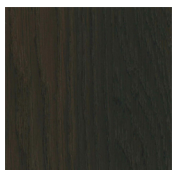

SPESSART
OAK

CLASS

FINISHINGS\SIDEBOARD\27 MAT LACQUERED COLOURS (27)



42 PANNA

35 CANAPA

26 CORDA

88 CASTORO

64 ARENA

46 TORTORA

48 VISONE

49 MOKA



61 QUARZO

62 CRETA

78 FERRO

04 GRAFITE

60 GHIACCIO

09 PIOGGIA

89 ROCCIA

90 PIOMBO



83 OCRA

85
CARAMELLO

72 CILIEGIA

87 GRANATA

84
PISTACCHIO

67 MUSCHIO

86 DANUBIO

70 PRUSSIA

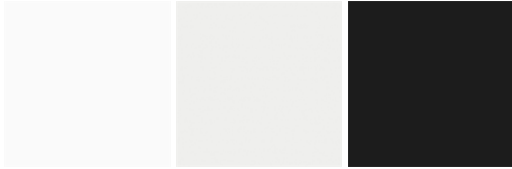

82 GLACIER-
WHITE

01 BIANCO

91 CARBONE